

Letterkenny Regional Sports Activity Hub

Volume II

Environmental Impact
Assessment Report (EIAR)
Figures and Drawings



- EXISTING SITE - 275,309M² / 27.5 HECTARES
- KEY:
- 1 1x 4G Synthetic Pitch (Pitch 1)
 - 2 1x Grass/Sand Competition Pitch (Pitch 2)
 - 3 2x Natural Grass Pitches with Cricket Crease (Pitch 3,4,5)
 - 4 4x Synthetic 5 Aside Soccer (Pitch 6,7,8,9)
 - 5 1x Hurling Wall
 - 7 1x Athletics Sprint Track
 - 8 Walking Track Loop with Bollard Lighting
 - 9 Outdoor Gym Equipment
 - 10 Playpark
 - 11 Pavilion Building
 - 12 Pavilion Building Air-Dome Annex
 - 13 Site Compound
 - 14 Biodiversity Garden
 - 15 Amphitheatre
 - 16 Community Garden
 - 17 Training Area
 - 18 Site access to be agreed with DCC

NOTES

ESB DIVERSION DRAWING TO BE READ WITH THE FOLLOWING DOCUMENTS:

- 2955-PMC-ESB-01
- 2955-PMC-ESB-02

BUILDERS WORK SCHEDULE

- CONTRACTOR SHALL CONSTRUCT NEW SUBSTATION ROOM AS PER ESB REQUIREMENTS
- CONTRACTOR TO PROVIDE NEW TRENCHING WITH 4 No. 125mm DUCTS
- CONTRACTOR TO PROVIDE ADDITIONAL TRENCH AND DUCTING AS REQUIRED
- CONTRACTOR SHALL CONSTRUCT PRECAST ESB VAULT AS REQUIRED
- CONTRACTOR TO ALLOW FOR EXCAVATED PITS AS PER ESB REQUIREMENTS
- CONTRACTOR TO PROVIDE NEW TRENCHING WITH 4 No. 125mm DUCTS FORM NEW TRIPLE POLE STRUCTURE
- ESB TO CARRY OUT INVESTIGATION INTO EXISTING DUCTING INFRASTRUCTURE. CONTRACTOR TO ALLOW FOR ADDITIONAL DUCTING AS REQUIRED.

ALSO SEE 2955-PMC-ESB-02 FOR FULL BUILDERS WORK SCHEDULE AND ROUTE DESCRIPTIONS

UTILITY SERVICES LEGEND

- ESB MV OVERHEAD CABLING
- ESB HV OVERHEAD CABLING
- ESB MV DUCTING
- ESB HV DUCTING
- EIRCOM DUCTING
- STREET LIGHT DUCTING

-	PRELIMINARY ISSUE	08/06/23
-	PRELIMINARY ISSUE	26/05/23
-	PRELIMINARY ISSUE - UPDATED XREF	17/05/23
-	PRELIMINARY ISSUE	DEC 22
REV	DESCRIPTION	DATE

PRELIMINARY

THESE DRAWINGS ARE TO BE USED TO FACILITATE AN UNDERSTANDING OF THE SCOPE AND CONTENT OF THE WORKS AND FOR PRICING PURPOSES. THE DRAWINGS ARE SUBJECT TO THE CONTRACTORS DETAILED DESIGN. FOLLOWING THE DESIGN INTENT IN THE PERFORMANCE SPECIFICATIONS. THE DRAWINGS ARE NOT TO BE USED AS THE BASIS FOR CONSTRUCTION.



JOB DESCRIPTION: LYIT REGIONAL SPORTS ACTIVITY HUB, LETTERKENNY, Co. DONEGAL

DWG TITLE: ESB DIVERSION (OPTION 1) ELECTRICAL SERVICES INSTALLATION PROPOSED BUILDERS WORKS

SCALE: 1:1000 DRAWN BY: [blank] VS ENG: PM/C DATE: JUN 23

DRAWING No. 2955-PMC-ZZ-ZZ-DR-ESB-0001

REVISION: -

EXISTING SITE - 275,309M² / 27.5 HECTARES

KEY:

- 1 1x 4G Synthetic Pitch (Pitch 1)
- 2 1x Grass/Sand Competition Pitch (Pitch 2)
- 3 2x Natural Grass Pitches with Cricket Crease (Pitch 3,4,5)
- 4 4x Synthetic 5 Aside Soccer (Pitch 6,7,8,9)
- 5 1x Hurling Wall
- 7 1x Athletics Sprint Track
- 8 Walking Track Loop with Bollard Lighting
- 9 Outdoor Gym Equipment
- 10 Playpark
- 11 Pavilion Building
- 12 Pavilion Building Air-Dome Annex
- 13 Site Compound
- 14 Biodiversity Garden
- 15 Amphitheatre
- 16 Community Garden
- 17 Training Area
- 18 Site access to be agreed with DCC

NOTES

ESB DIVERSION DRAWING TO BE READ WITH THE FOLLOWING DOCUMENTS:

- 2955-PMC-ESB-01
- 2955-PMC-ESB-02

BUILDERS WORK SCHEDULE

- CONTRACTOR SHALL CONSTRUCT NEW SUBSTATION ROOM AS PER ESB REQUIREMENTS
- CONTRACTOR TO PROVIDE NEW TRENCHING WITH 4 No. 125mm DUCTS
- CONTRACTOR TO PROVIDE ADDITIONAL TRENCH AND DUCTING AS REQUIRED
- CONTRACTOR SHALL CONSTRUCT PRECAST ESB VAULT AS REQUIRED
- CONTRACTOR TO ALLOW FOR EXCAVATED PITS AS PER ESB REQUIREMENTS
- CONTRACTOR TO PROVIDE NEW TRENCHING WITH 4 No. 125mm DUCTS FORM NEW TRIPLE POLE STRUCTURE
- ESB TO CARRY OUT INVESTIGATION INTO EXISTING DUCTING INFRASTRUCTURE. CONTRACTOR TO ALLOW FOR ADDITIONAL DUCTING AS REQUIRED.

ALSO SEE 2955-PMC-ESB-02 FOR FULL BUILDERS WORK SCHEDULE AND ROUTE DESCRIPTIONS

UTILITY SERVICES LEGEND

- ESB MV OVERHEAD CABLING
- ESB HV OVERHEAD CABLING
- ESB MV DUCTING
- ESB HV DUCTING
- EIRCOM DUCTING
- STREET LIGHT DUCTING

PRELIMINARY

THESE DRAWINGS ARE TO BE USED TO FACILITATE AN UNDERSTANDING OF THE SCOPE AND CONTENT OF THE WORKS AND FOR PRICING PURPOSES. THE DRAWINGS ARE SUBJECT TO THE CONTRACTORS DETAILED DESIGN. FOLLOWING THE DESIGN INTENT IN THE PERFORMANCE SPECIFICATIONS. THE DRAWINGS ARE NOT TO BE USED AS THE BASIS FOR CONSTRUCTION.



JOB DESCRIPTION: LYIT REGIONAL SPORTS ACTIVITY HUB, LETTERKENNY, Co. DONEGAL

DWG TITLE: ESB DIVERSION (OPTION 2) ELECTRICAL SERVICES INSTALLATION PROPOSED BUILDERS WORKS

SCALE: 1:1000 DRAWN BY: [] VS ENG: [] PK&C: [] DATE: JUN 23

DRAWING No: 2955-PMC-ZZ-ZZ-DR-ESB-0002

REVISION: -

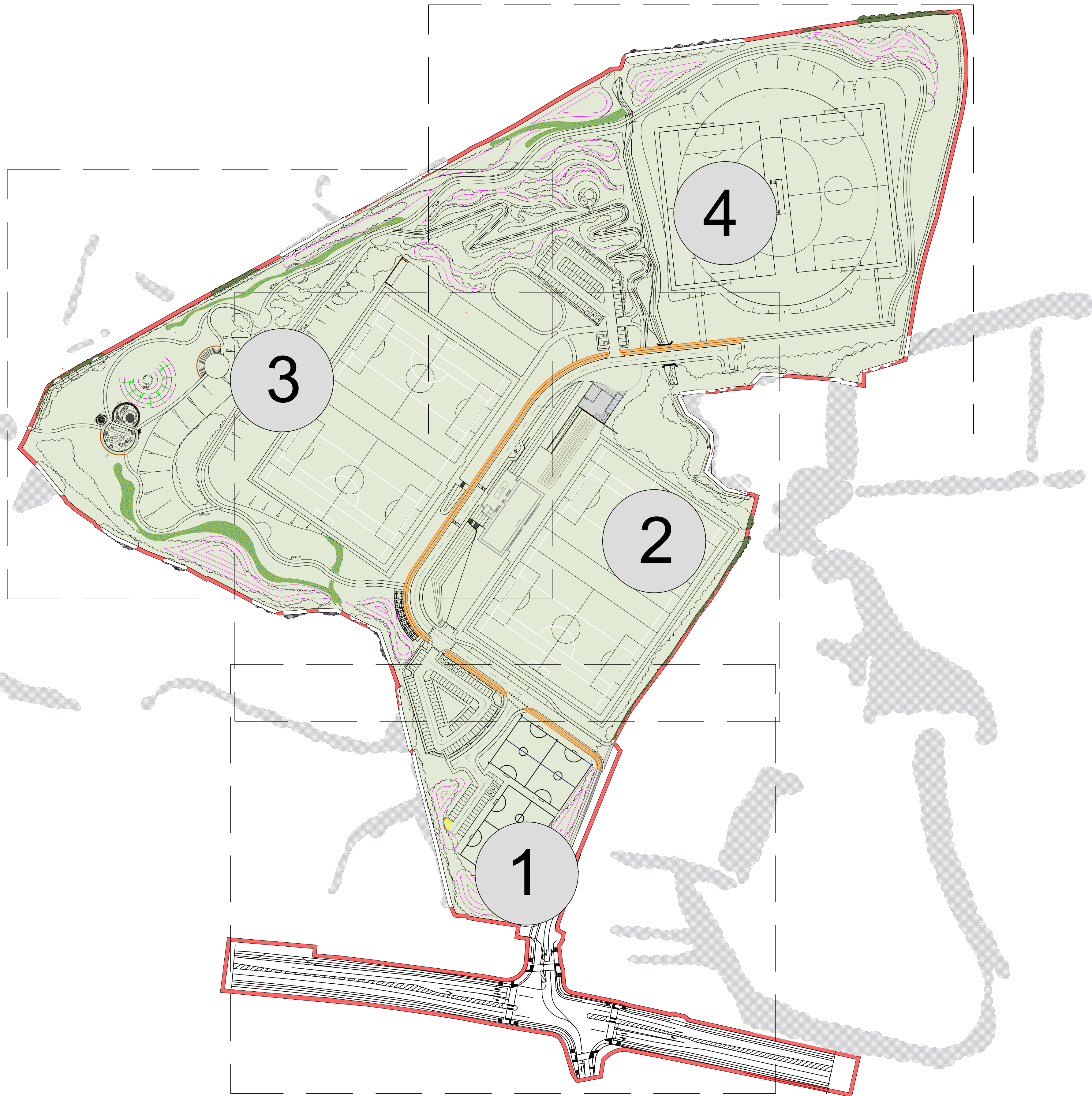
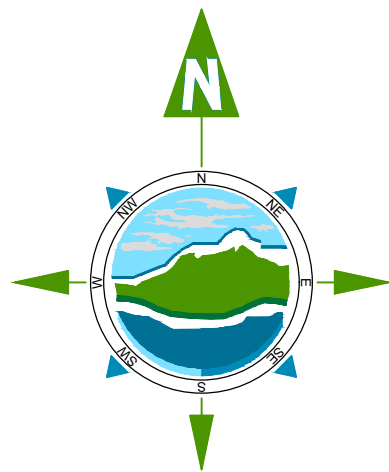

THE INFORMATION ON THIS DRAWING
IS TO THE ORDNANCE SURVEY IRELAND
ITM COORDINATE SYSTEM

Legend

Site Boundary

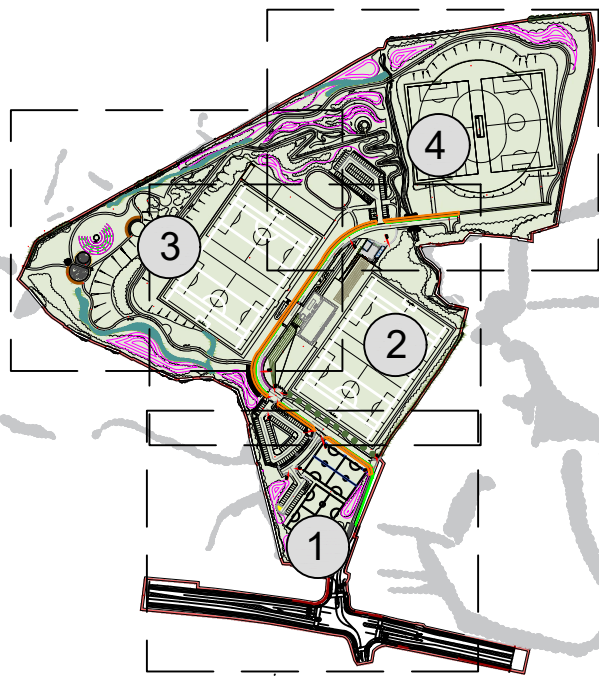

Key Plan

- NOTES:
1. FIGURED DIMENSIONS ONLY TO BE TAKEN FROM THIS DRAWING.
 2. ALL DRAWINGS TO BE CHECKED BY THE CONTRACTOR ON SITE.
 3. ENGINEER/EMPLOYERS REPRESENTATIVE, AS APPROPRIATE, TO BE INFORMED BY THE CONTRACTOR OF ANY DISCREPANCIES BEFORE ANY WORK COMMENCES.
 4. THE CONTRACTOR SHALL UNDERTAKE A THOROUGH CHECK FOR THE ACTUAL LOCATION OF ALL SERVICES/UTILITIES ABOVE AND BELOW GROUND, BEFORE ANY WORK COMMENCES.
 5. ALL LEVELS SHOWN RELATE TO ORDNANCE SURVEY DATUM AT MALIN HEAD.

P01	19/06/2023	Issued for Planning	RM	RB
Rev	Date	Description	By	Chkd.

Client: ATU Donegal

Project: Letterkenny Regional Sports Activity Hub

Title: Masterplan

Scale @ A1: 1:1500

Prepared by: RM Checked: RB Date: June 2023

Project Director: Brian Carroll

Drawing Status: Planning

TOBIN
CONSULTING ENGINEERS

Galway Office
Fairgreen House, Fairgreen Road,
Galway,
H91 AXK8,
Ireland.

Tel: +353 (0)91 565 211
www.tobin.ie

TOBIN Consulting Engineers will not be liable for any use of this document for any purpose other than that for which it was originally prepared and provided. Except where specifically and explicitly agreed in writing by TOBIN Consulting Engineers, no copyright holder, no part of this document may be reproduced or transmitted in any form and this document shall not be relied upon by any third party for any purpose.

Revision:

Drawing No.: 11438-2000P01

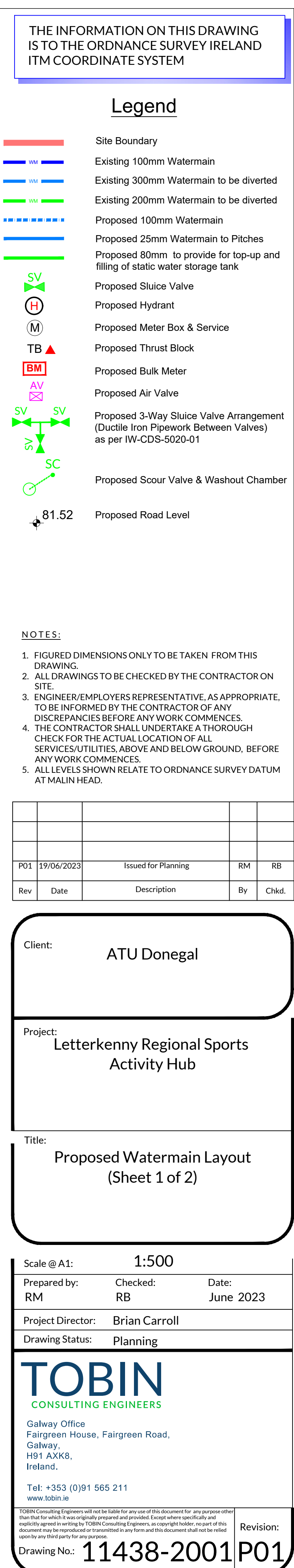

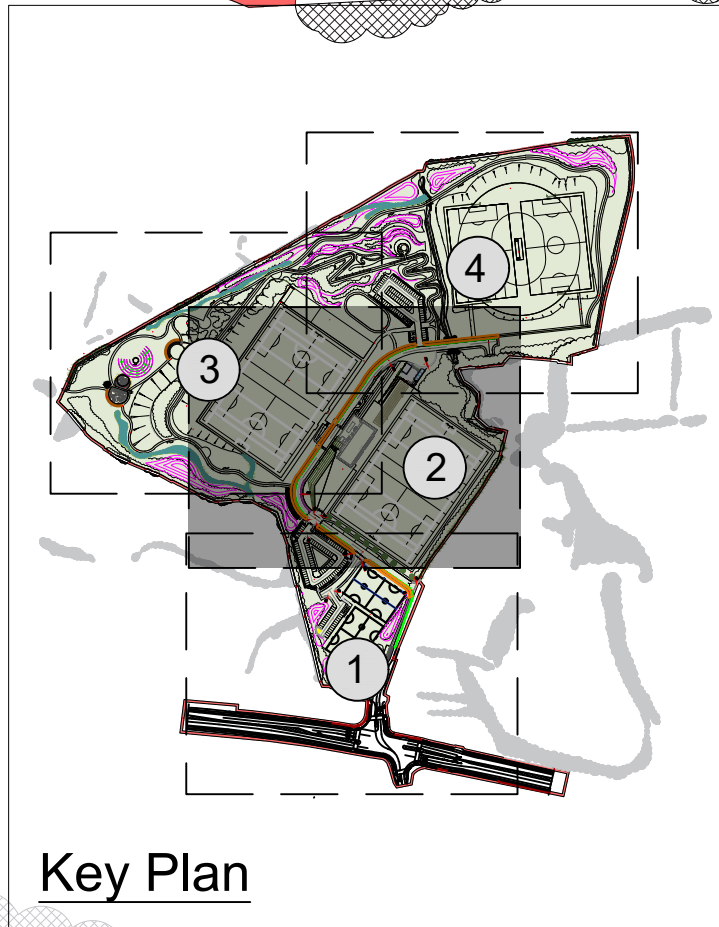
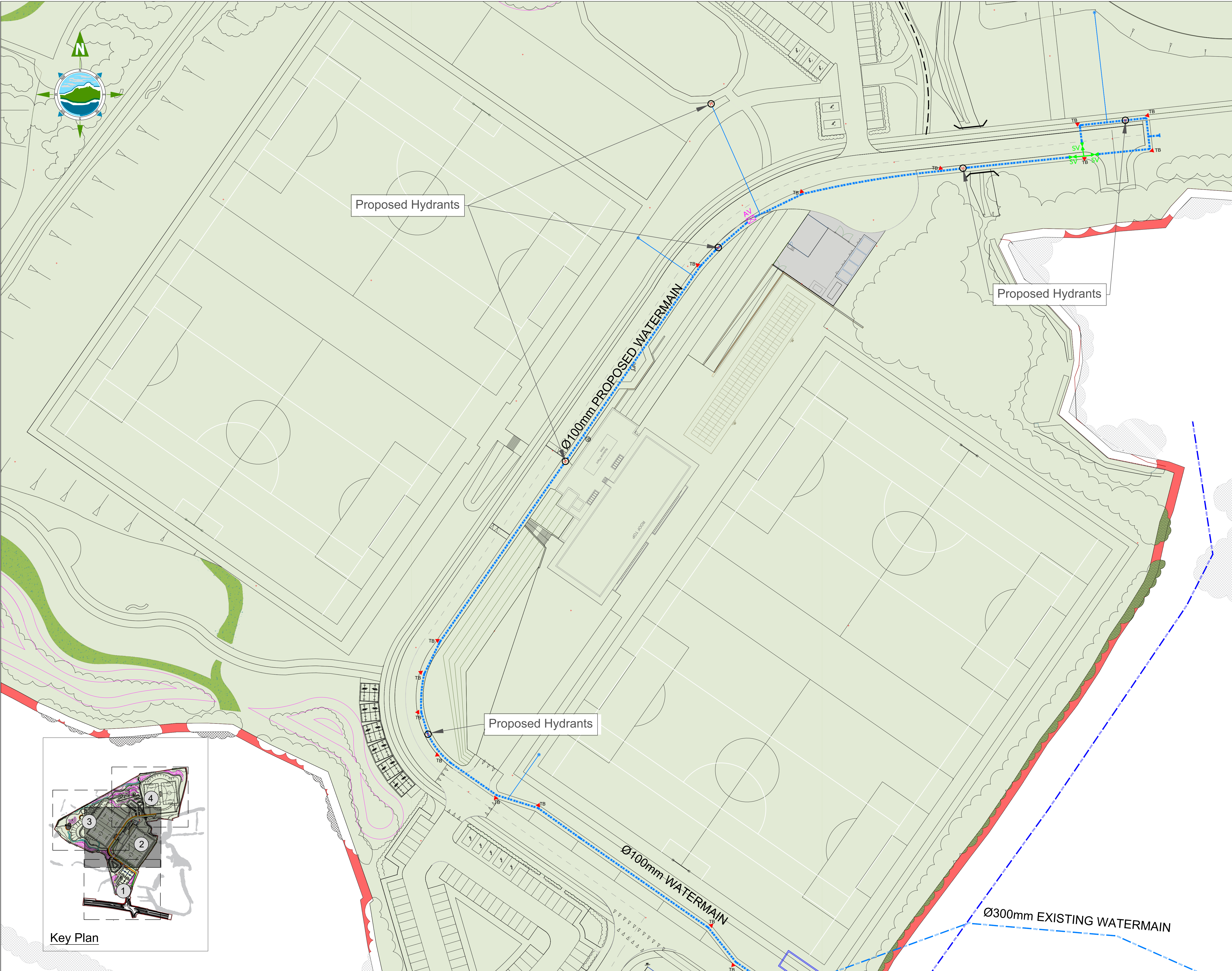

Key Plan

THE INFORMATION ON THIS DRAWING
IS TO THE ORDNANCE SURVEY IRELAND
ITM COORDINATE SYSTEM

Legend

- Site Boundary
- Existing 100mm Watermain
- Existing 300mm Watermain to be diverted
- Existing 200mm Watermain to be diverted
- Proposed 100mm Watermain
- Proposed 25mm Watermain to Pitches
- Proposed 80mm to provide for top-up and filling of static water storage tank
- Proposed Grassed Track
- Proposed Sluice Valve
- Proposed Hydrant
- Proposed Meter Box & Service
- Proposed Thrust Block
- Proposed Bulk Meter
- Proposed Air Valve
- Proposed 3-Way Sluice Valve Arrangement (Ductile Iron Pipework Between Valves) as per IW-CDS-5020-01
- Proposed Scour Valve & Washout Chamber
- Proposed Road Level

NOTES:

- FIGURED DIMENSIONS ONLY TO BE TAKEN FROM THIS DRAWING.
- ALL DRAWINGS TO BE CHECKED BY THE CONTRACTOR ON SITE.
- ENGINEER/EMPLOYERS REPRESENTATIVE, AS APPROPRIATE, TO BE INFORMED BY THE CONTRACTOR OF ANY DISCREPANCIES BEFORE ANY WORK COMMENCES.
- THE CONTRACTOR SHALL UNDERTAKE A THOROUGH CHECK FOR THE ACTUAL LOCATION OF ALL SERVICES/UTILITIES, ABOVE AND BELOW GROUND, BEFORE ANY WORK COMMENCES.
- ALL LEVELS SHOWN RELATE TO ORDNANCE SURVEY DATUM AT MALIN HEAD.

P01	19/06/2023	Issued for Planning	RM	RB
Rev	Date	Description	By	Chkd.

Client: ATU Donegal

Project: Letterkenny Regional Sports Activity Hub

Title: Proposed Watermain Layout (Sheet 2 of 2)

Scale @ A1: 1:500

Prepared by: RM Checked: RB Date: June 2023

Project Director: Brian Carroll

Drawing Status: Planning

TOBIN
CONSULTING ENGINEERS

Galway Office
Fairgreen House, Fairgreen Road,
Galway,
H91 AXK8,
Ireland.

Tel: +353 (0)91 565 211
www.tobin.ie

TOBIN Consulting Engineers will not be liable for any use of this document for any purpose other than that for which it was originally prepared and provided. Except where specifically and explicitly agreed in writing by TOBIN Consulting Engineers, no copyright notice, no part of this document may be reproduced or transmitted in any form and this document shall not be relied upon by any third party for any purpose.

Drawing No.: 11438-2002P01

Revision:

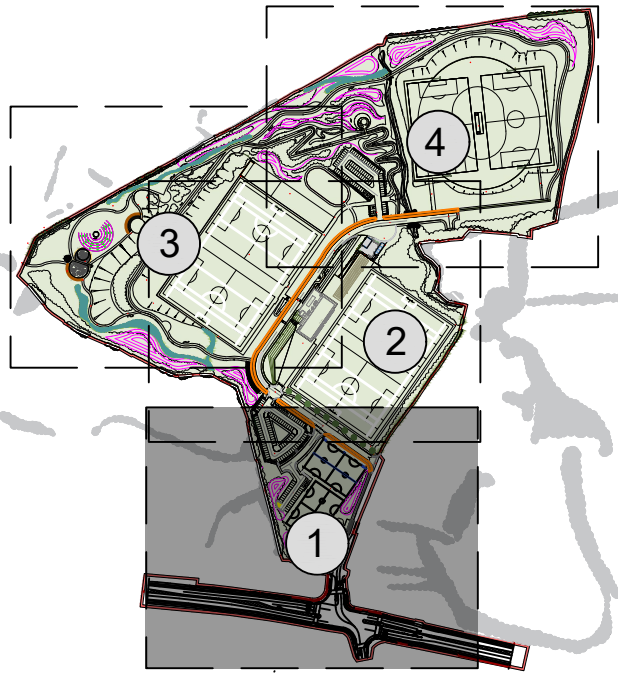
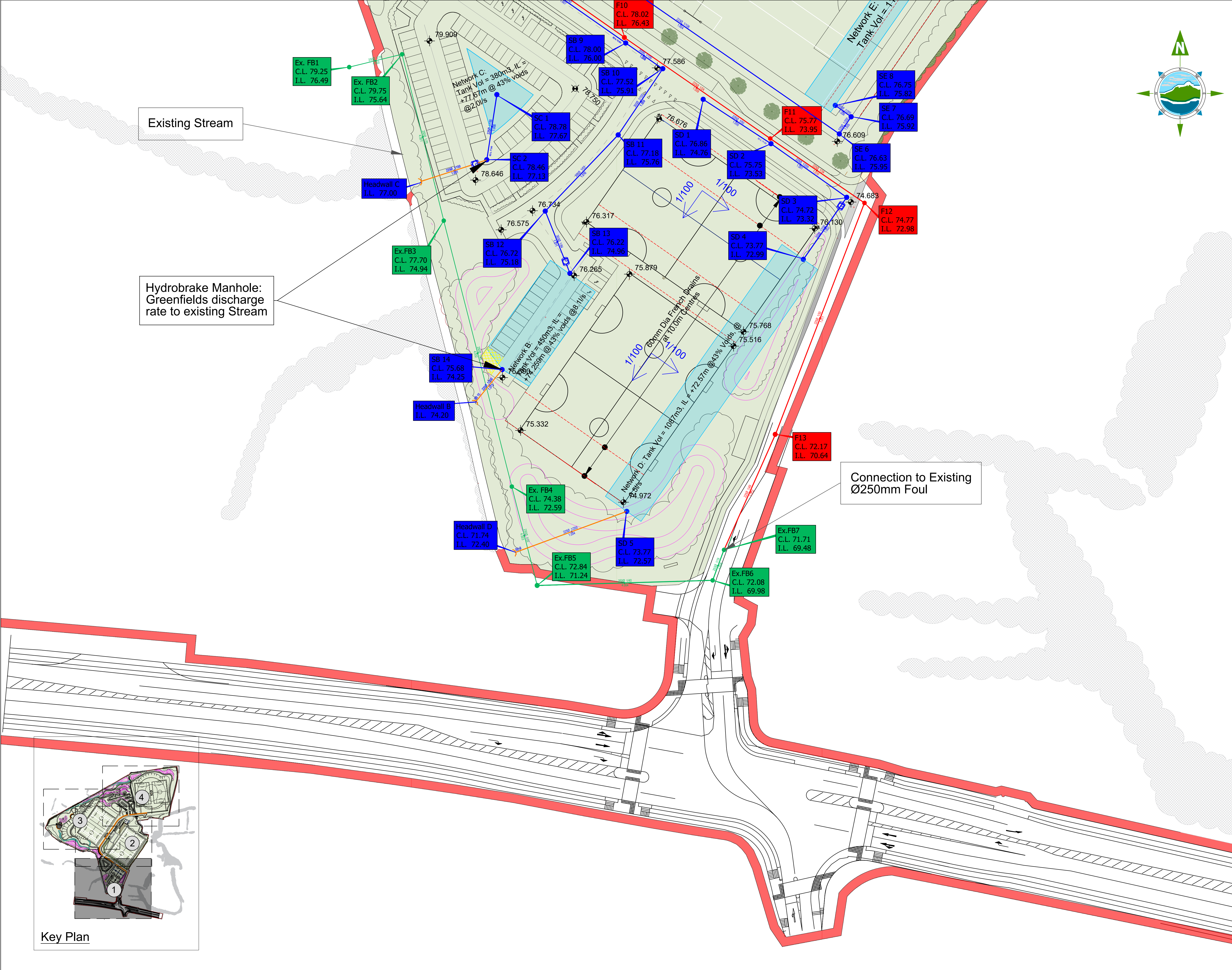

Key Plan

THE INFORMATION ON THIS DRAWING IS TO THE ORDNANCE SURVEY IRELAND ITM COORDINATE SYSTEM

Legend

- Site Boundary
- Proposed 60mm French Drain
- Proposed Silt Drain
- Proposed Storm Discharge - Stream
- Existing Foul Sewer
- Proposed Foul Sewer
- Proposed Storm
- Proposed Level
- Proposed Minor Foul
- Proposed Petrol interceptor
- Soakaway/Attenuation units

NOTES:

- FIGURED DIMENSIONS ONLY TO BE TAKEN FROM THIS DRAWING.
- ALL DRAWINGS TO BE CHECKED BY THE CONTRACTOR ON SITE.
- ENGINEER/EMPLOYERS REPRESENTATIVE, AS APPROPRIATE, TO BE INFORMED BY THE CONTRACTOR OF ANY DISCREPANCIES BEFORE ANY WORK COMMENCES.
- THE CONTRACTOR SHALL UNDERTAKE A THOROUGH CHECK FOR THE ACTUAL LOCATION OF ALL SERVICES/UTILITIES, ABOVE AND BELOW GROUND, BEFORE ANY WORK COMMENCES.
- ALL LEVELS SHOWN RELATE TO ORDNANCE SURVEY DATUM AT MALIN HEAD.

P01	19/06/2023	Issued for Planning	RM	RB
Rev	Date	Description	By	Chkd.

Client: ATU Donegal

Project: Letterkenny Regional Sports Activity Hub

Title: Proposed Drainage Layout (Sheet 1 of 4)

Scale @ A1: 1:500

Prepared by: RM
Checked: BH
Date: June 2023
Project Director: Brian Carroll
Drawing Status: Planning

TOBIN
CONSULTING ENGINEERS

Galway Office
Fairgreen House, Fairgreen Road,
Galway,
H91 AXK8,
Ireland.

Tel: +353 (0)91 565 211
www.tobin.ie

TOBIN Consulting Engineers will not be liable for any use of this document for any purpose other than that for which it was originally prepared and provided. Except where specifically and explicitly agreed in writing by TOBIN Consulting Engineers, no copyright holder, no part of this document may be reproduced or transmitted in any form and this document shall not be relied upon by any third party for any purpose.

Drawing No.: 11438-2003P01

Revision:

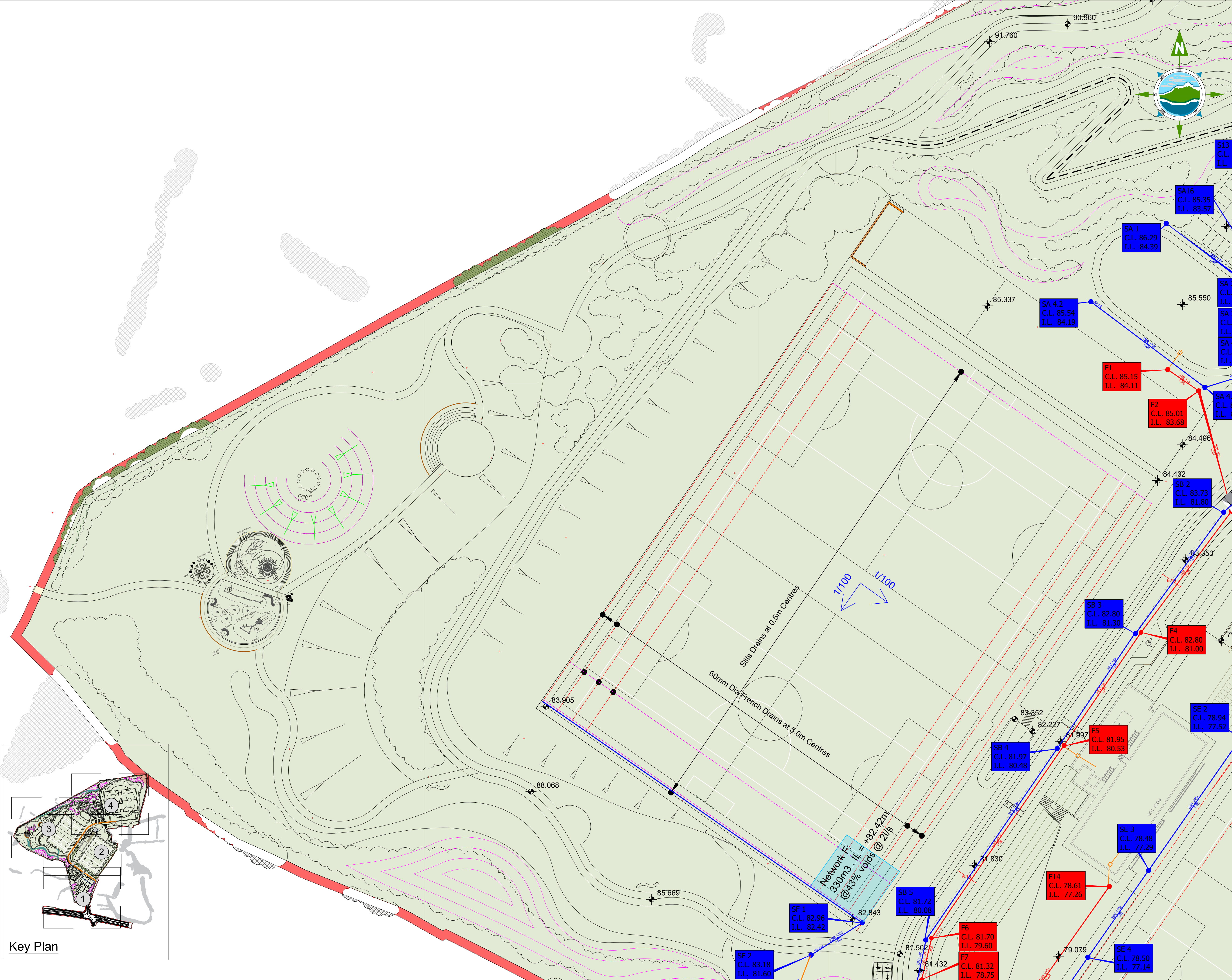

THE INFORMATION ON THIS DRAWING IS TO THE ORDNANCE SURVEY IRELAND ITM COORDINATE SYSTEM

Legend

Site Boundary

Proposed 60mm French Drain

Proposed Silt Drain

Proposed Storm Discharge - Stream

Existing Foul Sewer

Proposed Foul Sewer

Proposed Storm

Proposed Grassed Track

Proposed Level

Proposed Minor Foul

Proposed Petrol interceptor

Soakaway/Attenuation units

NOTES:

1. FIGURED DIMENSIONS ONLY TO BE TAKEN FROM THIS DRAWING.

2. ALL DRAWINGS TO BE CHECKED BY THE CONTRACTOR ON SITE.

3. ENGINEER/EMPLOYERS REPRESENTATIVE, AS APPROPRIATE, TO BE INFORMED BY THE CONTRACTOR OF ANY DISCREPANCIES BEFORE ANY WORK COMMENCES.

4. THE CONTRACTOR SHALL UNDERTAKE A THOROUGH CHECK FOR THE ACTUAL LOCATION OF ALL SERVICES/UTILITIES, ABOVE AND BELOW GROUND, BEFORE ANY WORK COMMENCES.

5. ALL LEVELS SHOWN RELATE TO ORDNANCE SURVEY DATUM AT MALIN HEAD.

P01	19/06/2023	Issued for Planning	RM	RB
Rev	Date	Description	By	Chkd.

Client:

ATU Donegal

Project:

Letterkenny Regional Sports Activity Hub

Title:

Proposed Drainage Layout (Sheet 3 of 4)

Scale @ A1:

1:500

Prepared by:

RM

Checked:

BH

Date:

June 2023

Project Director:

Brian Carroll

Drawing Status:

Planning

TOBIN

CONSULTING ENGINEERS

Galway Office

Fairgreen House, Fairgreen Road,

Galway,

H91 AXK8,

Ireland.

Tel: +353 (0)91 565 211

www.tobin.ie

TOBIN Consulting Engineers will not be liable for any use of this document for any purpose other than that for which it was originally prepared and provided. Except where specifically and explicitly agreed in writing by TOBIN Consulting Engineers, no copyright holder, no part of this document may be reproduced or transmitted in any form and this document shall not be relied upon by any third party for any purpose.

Revision:

Drawing No: 11438-2005 P01

Ordnance Survey Ireland Licence number CYAL50311153. © Ordnance Survey Ireland Government of Ireland

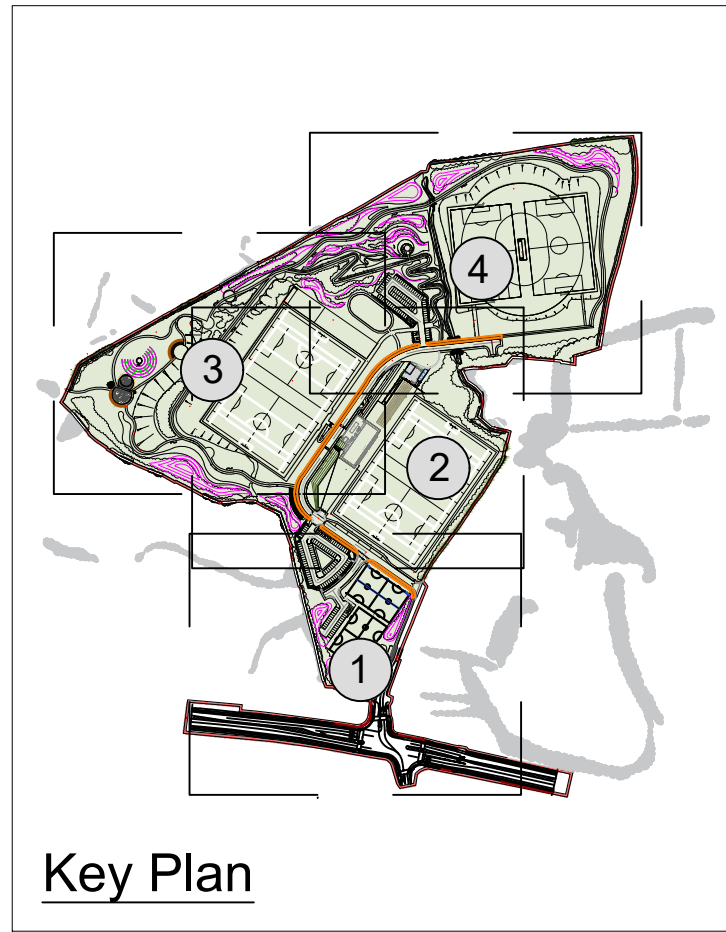

Key Plan

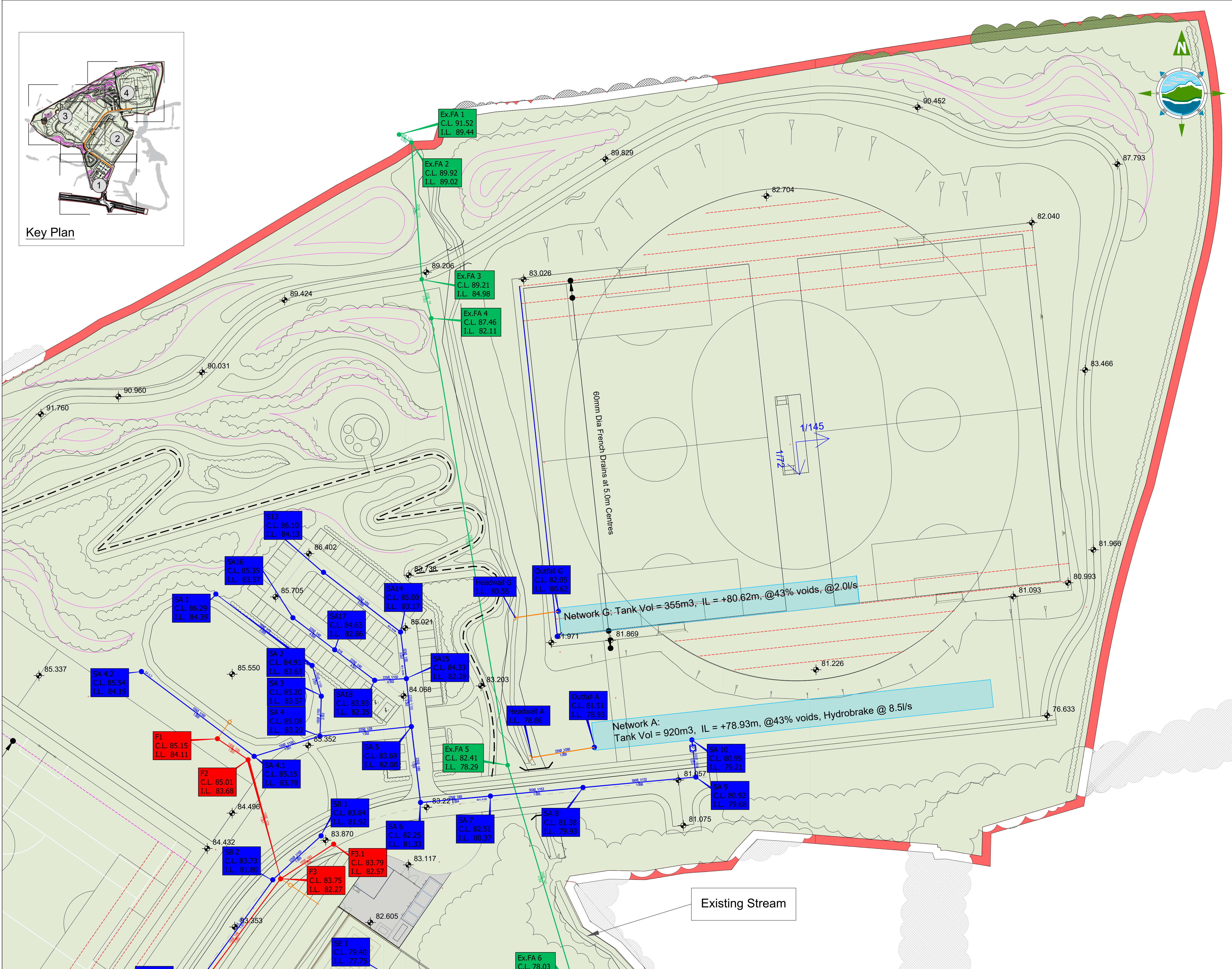

THE INFORMATION ON THIS DRAWING IS TO THE ORDNANCE SURVEY IRELAND ITM COORDINATE SYSTEM

Legend

Site Boundary

Proposed 60mm French Drain

Proposed Slit Drain

Proposed Storm Discharge - Stream

Proposed Grassed Track

Existing Foul Sewer

Proposed Foul Sewer

Proposed Storm

Proposed Level

Proposed Minor Foul

Proposed Petrel interceptor

Soakaway/Attenuation units

- NOTES:
- FIGURED DIMENSIONS ONLY TO BE TAKEN FROM THIS DRAWING.
 - ALL DRAWINGS TO BE CHECKED BY THE CONTRACTOR ON SITE.
 - ENGINEER/EMPLOYERS REPRESENTATIVE, AS APPROPRIATE, TO BE INFORMED BY THE CONTRACTOR OF ANY DISCREPANCIES BEFORE ANY WORK COMMENCES.
 - THE CONTRACTOR SHALL UNDERTAKE A THOROUGH CHECK FOR THE ACTUAL LOCATION OF ALL SERVICES/UTILITIES, ABOVE AND BELOW GROUND, BEFORE ANY WORK COMMENCES.
 - ALL LEVELS SHOWN RELATE TO ORDNANCE SURVEY DATUM AT MALIN HEAD.

P01	19/06/2023	Issued for Planning	RM	RB
Rev	Date	Description	By	Chkd.

Client:

ATU Donegal

Project:

Letterkenny Regional Sports Activity Hub

Title:

Proposed Drainage Layout
(Sheet 4 of 4)

Scale @ A1:		1:500
Prepared by:	Checked:	Date:
RM	BH	June 2023
Project Director:	Brian Carroll	
Drawing Status:	Planning	

TOBIN

CONSULTING ENGINEERS

Galway Office
Fairgreen House, Fairgreen Road,
Galway,
H91 AXK8,
Ireland.

Tel: +353 (0)91 565 211
www.tobin.ie

Revision:

Drawing No.: 11438-2006P01